

客户图

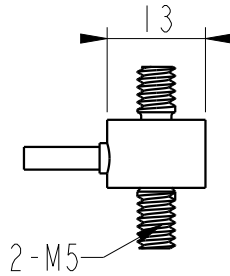
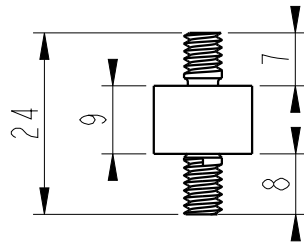
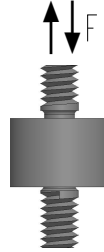
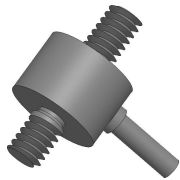

| MARK | DATE | ECO NO. | DESCRIPTION | REV. | DESIGN |
|------|------|---------|-------------|------|--------|
| ① | | | 首版发行 | 1 | Eric |

产品参数

| | |
|---------------------------------------|--|
| 测量范围 Rated capacity | 10, 20, 50, 100, 200, 500 N |
| 线性度 Nonlinearity | 0.5% Of rated output |
| 蠕变 Hysteresis | 0.5% of rated output |
| 重复性 Nonrepeatability | 0.5% of rated output |
| 灵敏度 Rated output, typical | 1.0 mv/v |
| 零点误差 Zero Balance | ±1% of rated output |
| 工作温度范围 Temperature Range, operating | -20~80℃ |
| 补偿温度范围 Temperature Range, compensated | -10~60℃ |
| 温度对输出的影响 Temperature Effect on Output | 0.05% of rated output/10℃ |
| 温度对零点的影响 Temperature Effect on Zero | 0.05% of rated output/10℃ |
| 输入电阻 Output Impedance | 350±30Ω |
| 输出电阻 Output Impedance | 350±5Ω |
| 标准激励电压 Excitation Voltage, typical | 5VDC |
| 最大激励电压 Excitation Voltage, maximum | 10VDC |
| 绝缘电阻 Insulation Resistance | ≥5000MΩ/100VDC |
| 安全过载 Maximum Load, safe | 120% of rated output |
| 破坏性过载 Maximum Load, ultimate | 150% of rated output |
| 防护等级 Protection class | IP66 |
| 材料 construction | Stainless steel |
| 接线定义 Wiring way | Exc+: Red Exc-: Black Sig+: Green Sig-: White |

- 超微型设计 Small size, low profile
- 优质不锈钢材料 Stainless steel, low deflection
- 拉压型 Tension&Compression only
- 防护等级 IP66 protection
- 定制化服务 Customizable size

BEDELL

苏州比得电子技术有限公司
suzhou Bedell Electric Technology Ltd

| 未标注尺寸公差 (±) | | | | |
|-------------|------|-----|-----|-----|
| 尺寸 | A | B | C | D |
| X≤4 | 0.05 | 0.1 | 0.2 | 0.3 |
| 4<X≤16 | 0.1 | 0.2 | 0.3 | 0.4 |
| 16<X≤63 | 0.2 | 0.3 | 0.4 | 0.7 |
| 63<X≤250 | 0.3 | 0.4 | 0.5 | 1.2 |
| X>250 | 0.4 | 0.5 | 0.8 | 2.0 |

| | | | | | | | | | | | |
|----------|------|------|----------|----------|------------|-------|-----|------|-----|-----|---|
| DESIGN | Eric | DATE | 23/03/24 | TITLE | Model 102D | | | | | | |
| VERIFIED | | | | PART NO. | | | | | | | |
| APPROVED | | | | | | | | | | | |
| | | | | UNITS | mm | SCALE | 1:1 | PAGE | 1/1 | REV | 1 |